



# PAVILLON MADRID 12' X 14' SÉVILLE 10' X 14'

12' x 14' Madrid Pavilion,  
Référence / Reference Madrid : 29769

10' x 14' Séville Pavilion  
Référence / Reference : 29758

---

## GUIDE D'ASSEMBLAGE Assembly Instructions

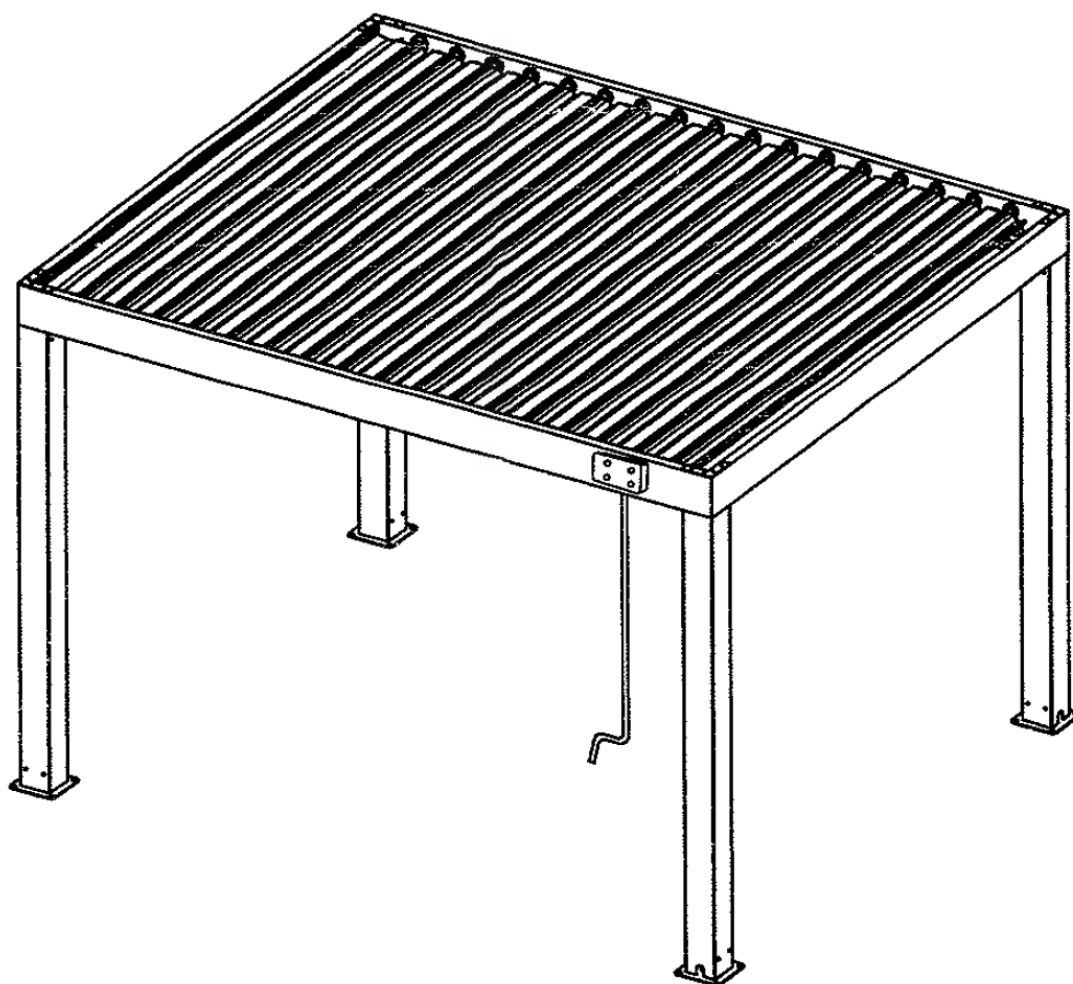

POUR TOUTE ASSISTANCE,  
CONTACTEZ VOTRE DÉTAILLANT.  
For assistance, contact your retailer.

Fabriqué en Chine / Made in China

# PRÉASSEMBLAGE / PRE-ASSEMBLY

## Liste des pièces / Parts List

Pièce/ Part	Description	Qté / Qty	Pièce/ Part	Description	Qté / Qty	Pièce/ Part	Description	Qté / Qty
<b>A</b>	M8x14	<b>x 32</b>	<b>B</b>	Rondelle/Washer M8	<b>x 32</b>	<b>C</b>	Boulon/Bolt M10D14x80mm	<b>x 16</b>
<b>D</b>	M6x200	<b>x 16</b>	<b>E</b>	Bouchon/Cap	<b>x 16</b>	<b>F</b>	M5x15	<b>x 38</b>
<b>G</b>	ST2.6x10	<b>x 160</b>	<b>H</b>	M6x16 + Écrou/Nut	<b>x 40</b>	<b>J</b>	Rondelle/Washer	<b>x 22</b>
<b>K</b>	Tournevis/ Screwdriver	<b>x 1</b>	<b>L</b>	M5x10	<b>x 40</b>	<b>M</b>	Clé hexagonale/ Allen Key	<b>x 2</b>
<b>N</b>	Clavette plate/ Flat Key	<b>x 1</b>	<b>P</b>	Crochet / Hook	<b>x 1</b>			

<b>1</b>	Poteau/Pole	<b>x 4</b>	<b>2</b>	Base/Base	<b>x 4</b>	<b>3</b>	Solive/Joist 4m2 #1	<b>x 1</b>
<b>4</b>	Solive/Joist 4m2 #2	<b>x 1</b>	<b>5</b>	Solive/Joist 3m6#1	<b>x 1</b>	<b>6</b>	Solive/Joist 3m6 #2	<b>x 1</b>
<b>7</b>	Connecteur de coin/ Corner Connector	<b>x 4</b>	<b>8</b>	Plaque en L/ L-Shape Plate	<b>x 4</b>	<b>9</b>	Lame/Louver	<b>x 20</b>
<b>10</b>	Barre en aluminium 22,5cm/ Aluminum Bar 22,5cm	<b>x 1</b>	<b>11</b>	Barre en aluminium 14cm/ Aluminum Bar 14cm	<b>x 39</b>	<b>12</b>	Plaque/Plate	<b>x 40</b>
<b>13</b>	Connecteur de lame/ Louver Connector	<b>x 2</b>	<b>14</b>	Gouttière 4m1/ 4m1 Gutter	<b>x 2</b>	<b>15</b>	Gouttière de bout/ End Gutter N°1	<b>x 1</b>
<b>16</b>	Gouttière de bout/ End Gutter N°2	<b>x 1</b>	<b>17</b>	Manivelle/Handle	<b>x 1</b>			

# ASSEMBLAGE / ASSEMBLY

## Étape / Step 1

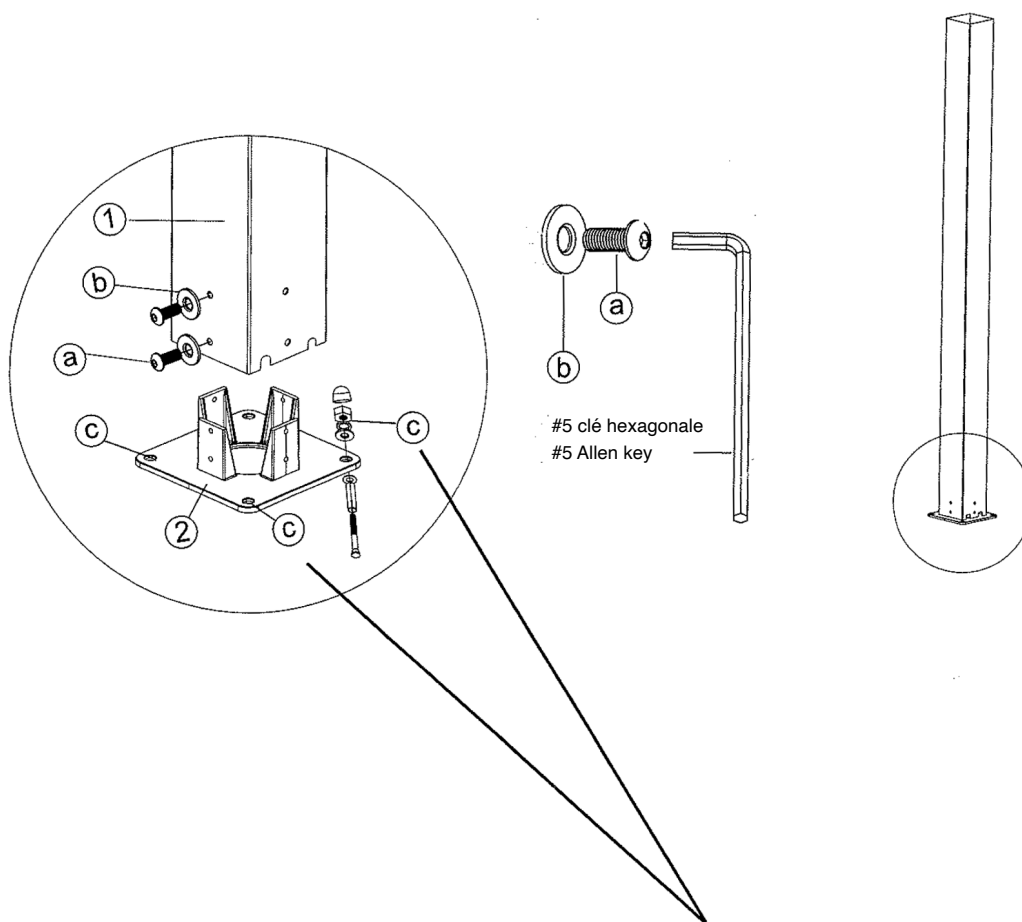

Il est possible d'ancrer les bases dans le sol en utilisant les boulons à expansion C, cependant, il est préférable de le faire lorsque le pavillon est placé dans sa position définitive.

It is possible to anchor the bases into the ground using expansion bolts C, however it is suggested to do this step once the pavilion is set on its final position.

# ASSEMBLAGE / ASSEMBLY

## Étape / Step 2

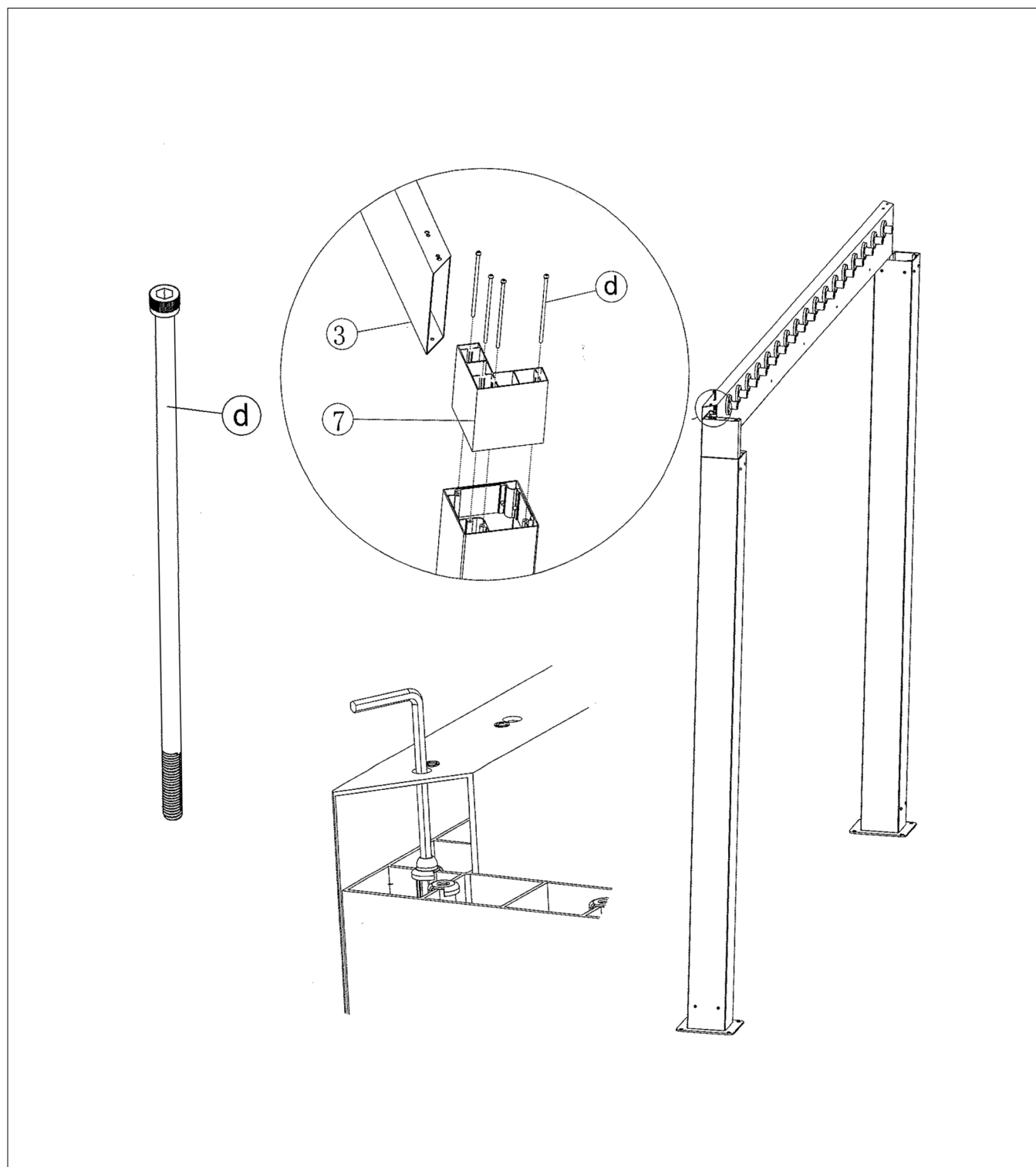

# ASSEMBLAGE / ASSEMBLY

## Étape / Step 3

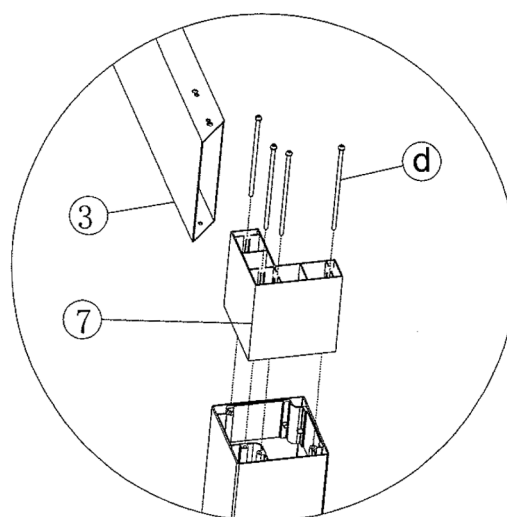
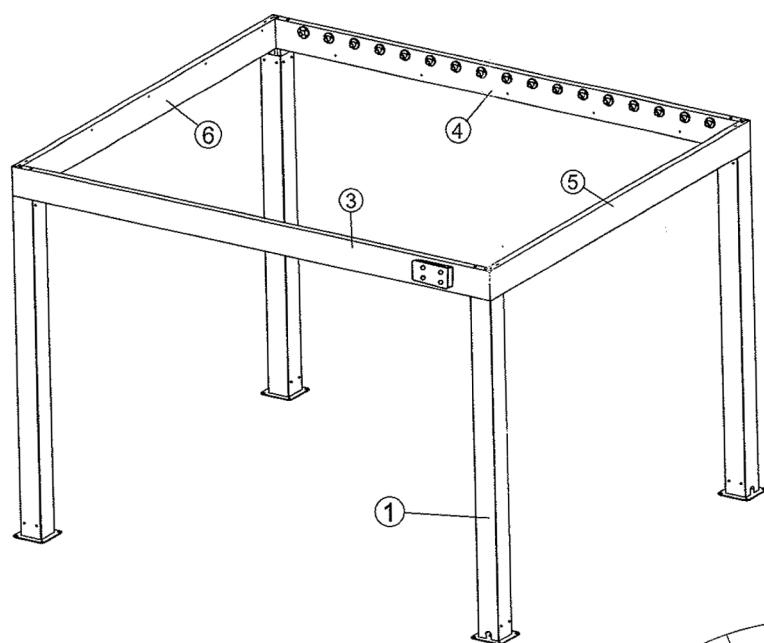

# ASSEMBLAGE / ASSEMBLY

## Étape / Step 4

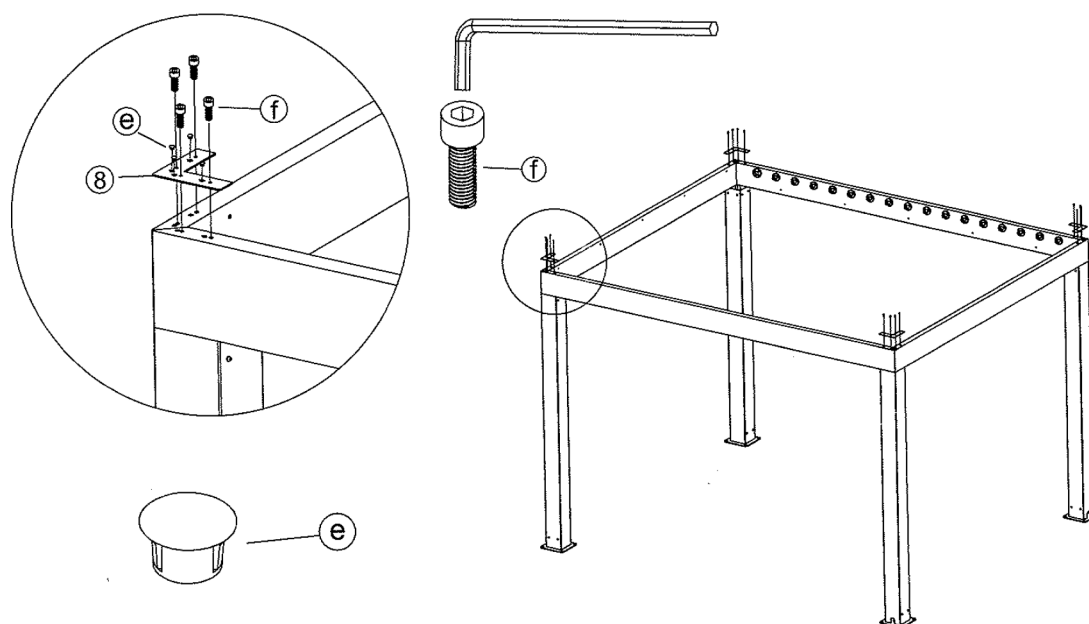

# ASSEMBLAGE / ASSEMBLY

## Étape / Step 5

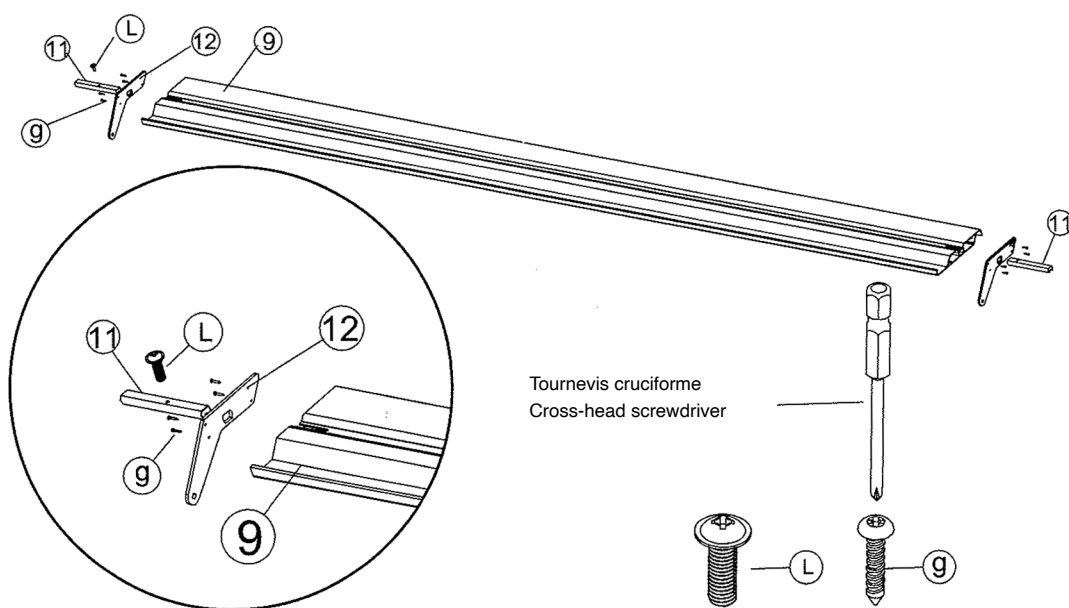

# ASSEMBLAGE / ASSEMBLY

## Étape / Step 6

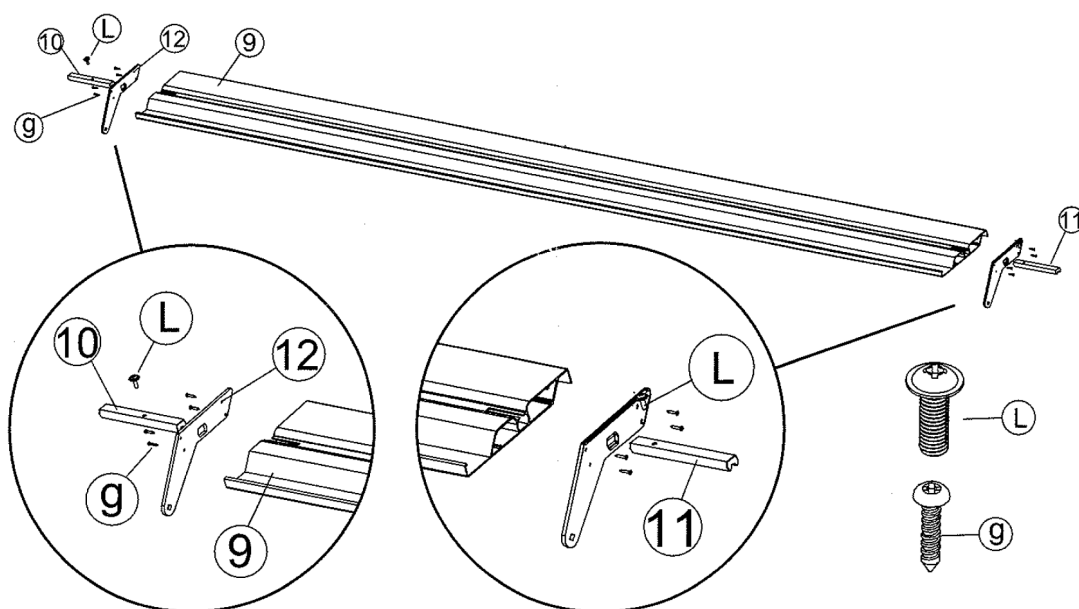



# ASSEMBLAGE / ASSEMBLY

## Étape / Step 7

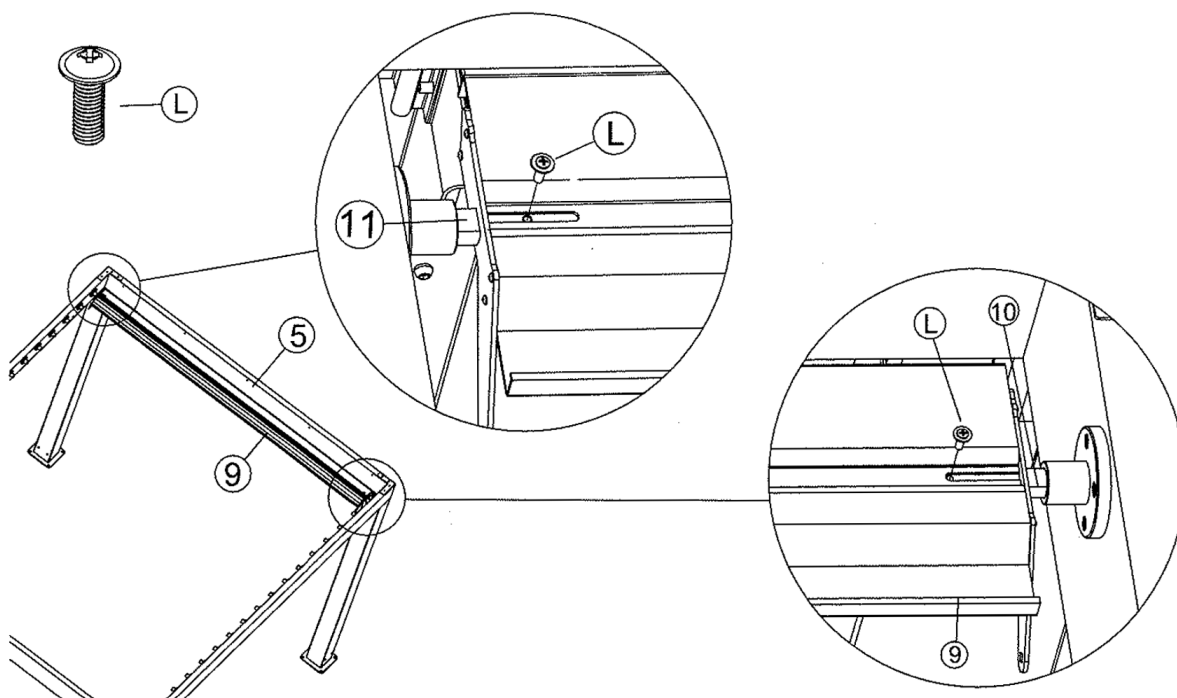

# ASSEMBLAGE / ASSEMBLY

## Étape / Step 8

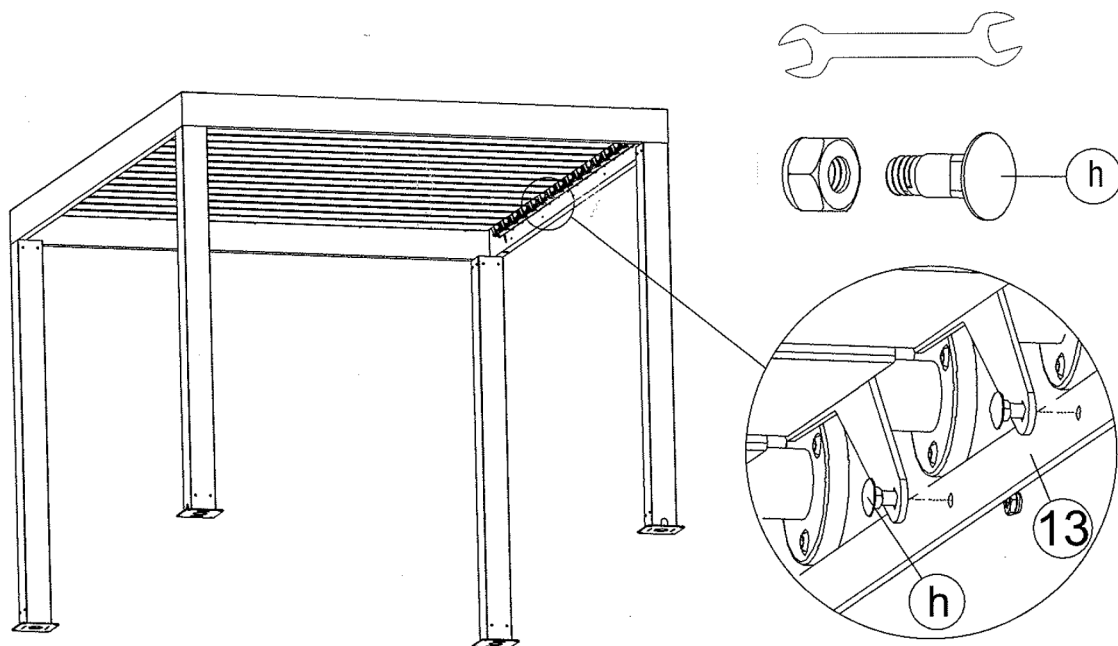

# ASSEMBLAGE / ASSEMBLY

## Étape / Step 9

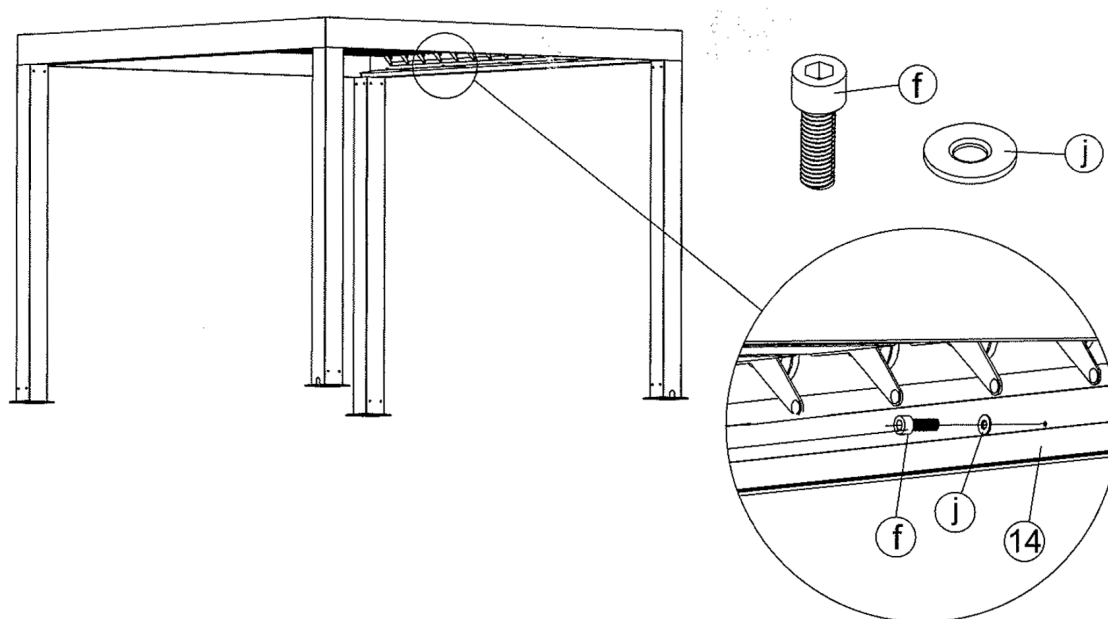

## ASSEMBLAGE / ASSEMBLY

Étape / Step 10

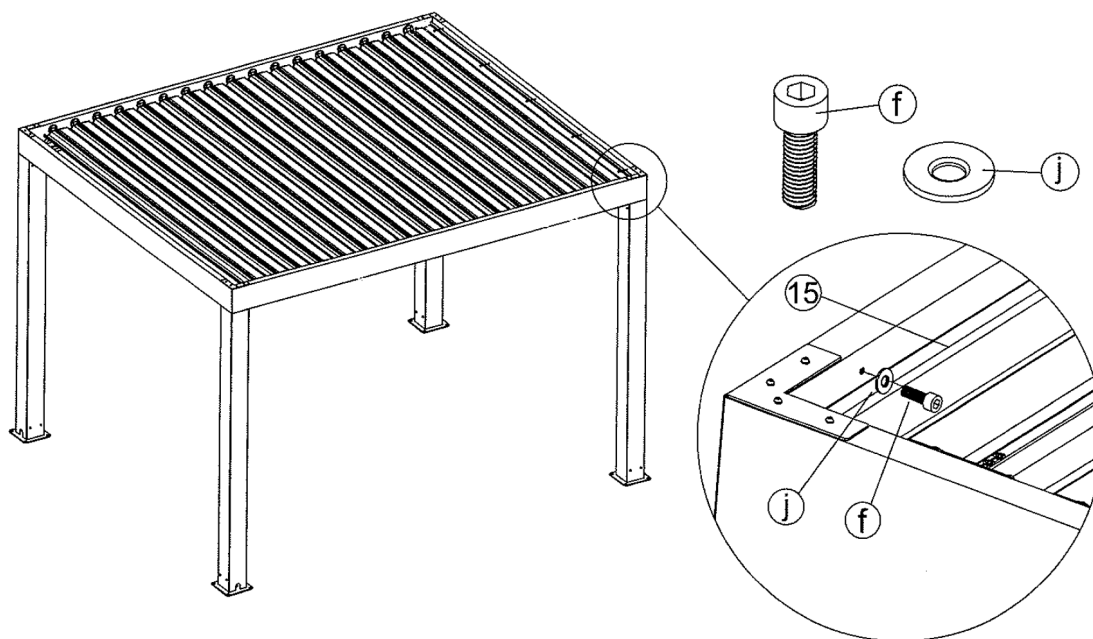

# ASSEMBLAGE / ASSEMBLY

## Étape / Step 11

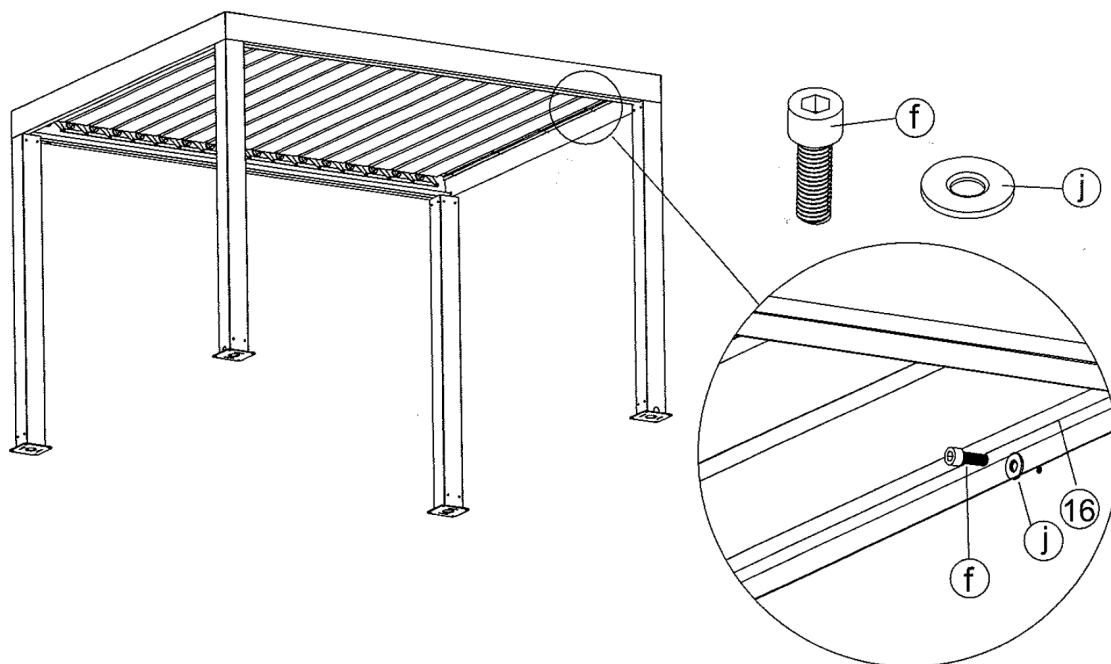

## ASSEMBLAGE / ASSEMBLY

Étape / Step 12

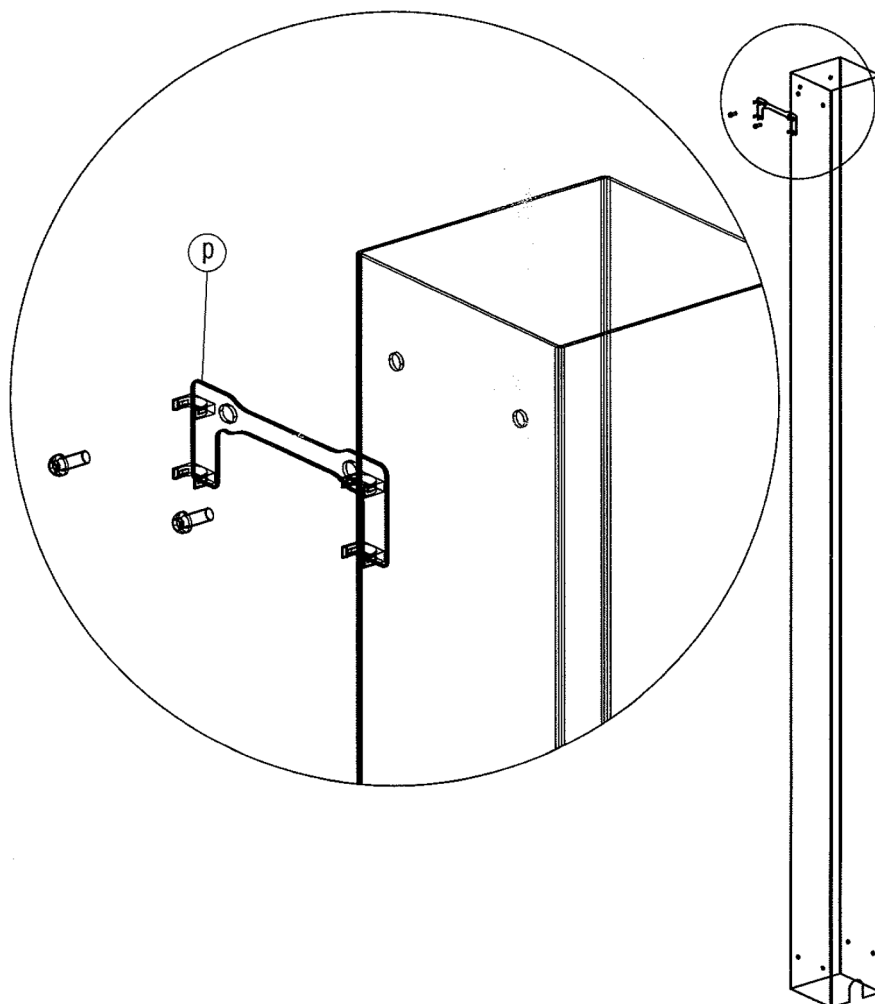

## ASSEMBLAGE / ASSEMBLY

### Étape / Step 13

